

# MINI-AI-520

---

Kneron KL520 NPU  
mPCIe MiniCard Module

User's Manual 2<sup>nd</sup> Ed

## Copyright Notice

---

This document is copyrighted, 2025. All rights are reserved. The original manufacturer reserves the right to make improvements to the products described in this manual at any time without notice.

No part of this manual may be reproduced, copied, translated, or transmitted in any form or by any means without the prior written permission of the original manufacturer. Information provided in this manual is intended to be accurate and reliable. However, the original manufacturer assumes no responsibility for its use, or for any infringements upon the rights of third parties that may result from its use.

The material in this document is for product information only and is subject to change without notice. While reasonable efforts have been made in the preparation of this document to assure its accuracy, AAEMON assumes no liabilities resulting from errors or omissions in this document, or from the use of the information contained herein.

AAEMON reserves the right to make changes in the product design without notice to its users.

## Acknowledgements

---

All other products' name or trademarks are properties of their respective owners.

- Microsoft Windows® and Windows® 10 are registered trademarks of Microsoft Corp.
- Ubuntu is a registered trademark of Canonical
- Kneron and the Kneron logo are trademarks of Kneron Inc.
- TensorFlow™ is a registered trademark of Google LLC
- Apache, Apache MXNet, and MXNet are registered trademarks of the Apache Software Foundation

All other product names or trademarks are properties of their respective owners. No ownership is implied or assumed for products, names or trademarks not herein listed by the publisher of this document.

# Packing List

---

Before setting up your product, please make sure the following items have been shipped:

Item	Quantity
● MINI-AI-520 M.2 Module	1
● M3 screw	2

If any of these items are missing or damaged, please contact your distributor or sales representative immediately.

## About this Document

---

This User's Manual contains all the essential information, such as detailed descriptions and explanations on the product's hardware and software features (if any), its specifications, dimensions, jumper/connector settings/definitions, and driver installation instructions (if any), to facilitate users in setting up their product.

Users may refer to the product page on [AAEON.com](http://AAEON.com) for the latest version of this document.

## Safety Precautions

---

Please read the following safety instructions carefully. It is advised that you keep this manual for future references

1. All cautions and warnings on the device should be noted.
2. Make sure the power source matches the power rating of the device.
3. Position the power cord so that people cannot step on it. Do not place anything over the power cord.
4. Always completely disconnect the power before working on the system's hardware.
5. No connections should be made when the system is powered as a sudden rush of power may damage sensitive electronic components.
6. If the device is not to be used for a long time, disconnect it from the power supply to avoid damage by transient over-voltage.
7. Always disconnect this device from any power supply before cleaning.
8. While cleaning, use a damp cloth instead of liquid or spray detergents.
9. Make sure the device is installed near a power outlet and is easily accessible.
10. Keep this device away from humidity.
11. Place the device on a solid surface during installation to prevent falls.
12. Do not cover the openings on the device to ensure optimal heat dissipation.
13. Watch out for high temperatures when the system is running.
14. Do not touch the heat sink or heat spreader when the system is running
15. Never pour any liquid into the openings. This could cause fire or electric shock.
16. As most electronic components are sensitive to static electrical charge, be sure to ground yourself to prevent static charge when installing the internal components. Use a grounding wrist strap and contain all electronic components in any static-shielded containers.

17. If any of the following situations arises, please the contact our service personnel:
  - i. Damaged power cord or plug
  - ii. Liquid intrusion to the device
  - iii. Exposure to moisture
  - iv. Device is not working as expected or in a manner as described in this manual
  - v. The device is dropped or damaged
  - vi. Any obvious signs of damage displayed on the device
18. Do not leave this device in an uncontrolled environment with temperatures beyond the device's permitted storage temperatures (see chapter 1) to prevent damage.
19. Do NOT disassemble the motherboard so as not to damage the system or void your warranty.
20. If the thermal pad had been damaged, please contact AAEON's salesperson to purchase a new one. Do NOT use those of other brands.
21. The Hex Cylinder Coppers on the front panel are not removable.
22. Repeatedly assemble and disassemble the system may cause damages to the exterior paint and surface and screw holes.
23. Use the right size screwdriver.
24. Use the screwdriver correctly to remove screws from the system.

## FCC Statement

---

### **Warning!**



This device complies with Part 15 FCC Rules. Operation is subject to the following two conditions: (1) this device may not cause harmful interference, and (2) this device must accept any interference received including interference that may cause undesired operation.

### **Caution:**

*There is a danger of explosion if the battery is incorrectly replaced. Replace only with the same or equivalent type recommended by the manufacturer. Dispose of used batteries according to the manufacturer's instructions and your local government's recycling or disposal directives.*

### **Attention:**

*Il y a un risque d'explosion si la batterie est remplacée de façon incorrecte. Ne la remplacer qu'avec le même modèle ou équivalent recommandé par le constructeur. Recycler les batteries usées en accord avec les instructions du fabricant et les directives gouvernementales de recyclage.*

China RoHS Requirements (CN)

产品中有毒有害物质或元素名称及含量

AAEON 主板/子板/背板

QQ4-381 Rev.A2

部件名称	有毒有害物质或元素					
	铅 (Pb)	汞 (Hg)	镉 (Cd)	六价铬 (Cr(VI))	多溴联苯 (PBB)	多溴二苯醚 (PBDE)
印刷电路板 及其电子组件	×	○	○	○	○	○
外部信号 连接器及线材	×	○	○	○	○	○
<p>本表格依据 SJ/T 11364 的规定编制。</p> <p>○：表示该有毒有害物质在该部件所有均质材料中的含量均在GB/T 26572标准规定的限量要求以下。</p> <p>×：表示该有害物质的某一均质材料超出了GB/T 26572的限量要求，然而该部件仍符合欧盟指令2011/65/EU 的规范。</p> <p>环保使用期限(EFUP (Environmental Friendly Use Period))：10年</p> <p>备注：此产品所标示之环保使用期限，系指在一般正常使用状况下。</p>						

China RoHS Requirement (EN)

Name and content of hazardous substances in product

AAEON Main Board/Daughter Board/Backplane

QO4-381 Rev.A2

Part Name	Hazardous Substances					
	铅 (Pb)	汞 (Hg)	镉 (Cd)	六价铬 (Cr(VI))	多溴联苯 (PBB)	多溴二苯醚 (PBDE)
PCB Assemblies	×	○	○	○	○	○
Connector and Cable	×	○	○	○	○	○
<p>The table is prepared in accordance with the provisions of SJ/T 11364.</p> <p>○: Indicates that said hazardous substance contained in all of the homogenous materials for this product is below the limit requirement of GB/T 26572.</p> <p>×: Indicates that said hazardous substance contained in at least one of the homogenous materials used for this part is above the limit requirement of GB/T 26572.</p> <p>But this product still be compliance with 2011/65/EU Directive (allowed with 2011/65/EU Annex III of RoHS exemption with number 6(c),7(a),7(c)-1).</p> <p>EFUP (Environment Friendly Use Period) value: 10 years</p> <p>Notes: This product defined period of use is under normal condition.</p>						

Table of Contents

---

Chapter 1 - Product Specifications ..... 1

1.1 MINI-AI-520 Kneron NPU Module Specifications ..... 2

Chapter 2 – Hardware Information ..... 3

2.1 Dimensions ..... 4

2.2 Block Diagram..... 5

2.3 Board Design..... 6

2.4 List of Connectors .....7

2.4.1 UART Connector (CN2) .....7

2.4.2 UART Connector (CN3) ..... 8

2.4.3 Mini-Card Connector (CN4) ..... 8

Appendix A – Toolchain User Manual..... 10

A.1 Toolchain User Manual.....11

# Chapter 1

---

Product Specifications

## 1.1 MINI-AI-520 Kneron NPU Module Specifications

### System

IC	Kneron KL520
Type	Integrated SoC
Support Framework	ONNX, TensorFlow, Keras, Caffe
Support Model	Vgg16, Resnet, GoogleNet, YOLO, Tiny YOLO, Lenet, MobileNet, DenseNet
Memory Type	LPDDR2
NPU Power Efficiency	0.56TOPS/W
Overall Power Consumption	0.5W

### Other Specifications

Operating Temperature	32°F ~ 158°F (0°C ~ 70°C)
Storage Temperature	-40°F ~ 185°F (-40°C ~ 85°C)
Operating Humidity	0% ~ 90% relative humidity, non-condensing
Certification	CE/FCC Class A

# Chapter 2

---

Hardware Information

## 2.1 Dimensions

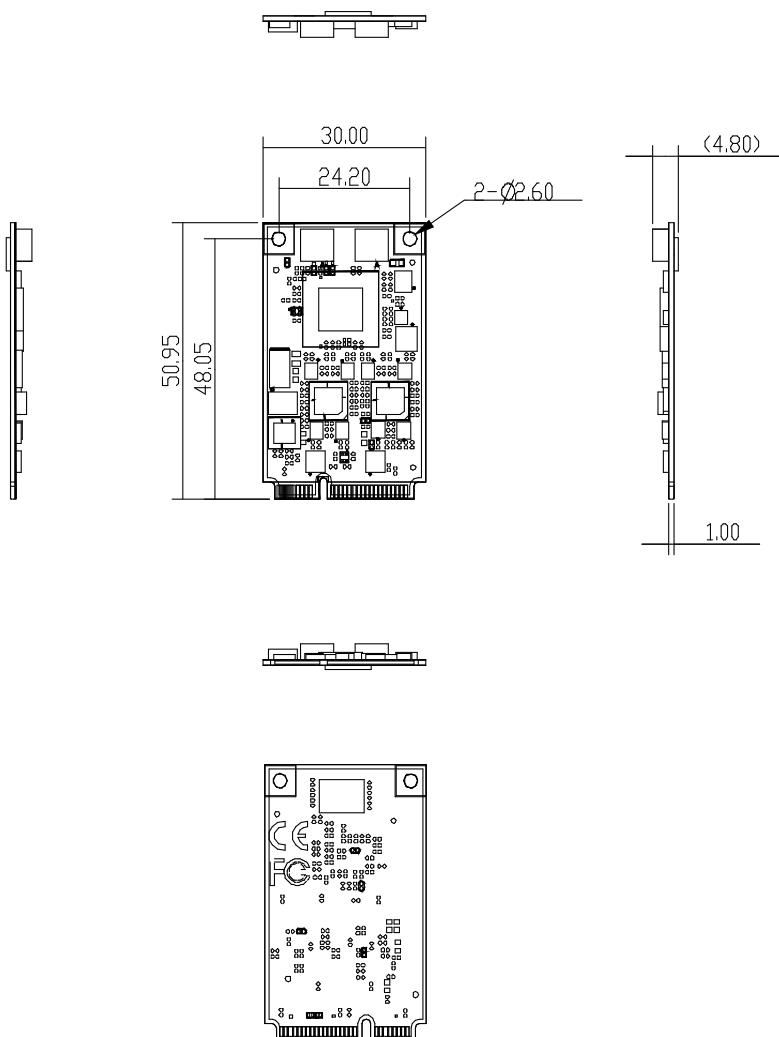

## 2.2 Block Diagram

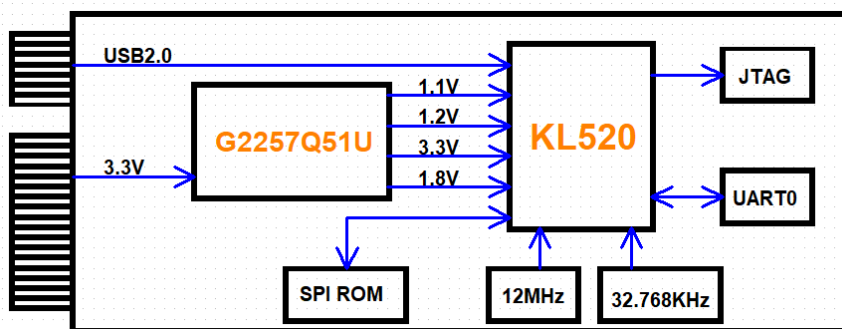

## 2.3 Board Design

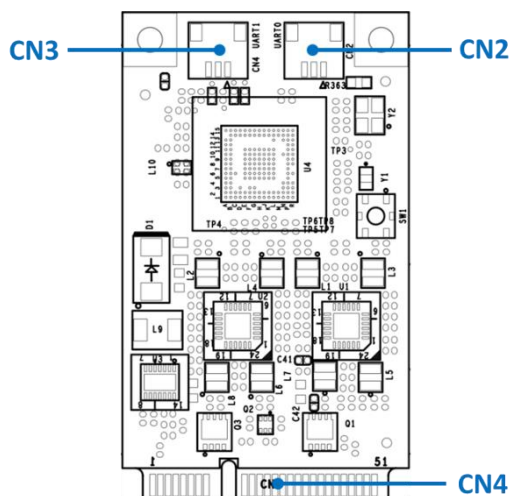

## 2.4 List of Connectors

This section details the connectors featured on the AI Core X module. This is a reference to help with setup and configuration for your application.

Label	Connector Type
CN2	UART Connector
CN3	UART Connector
CN4	Mini-Card Connector

### 2.4.1 UART Connector (CN2)

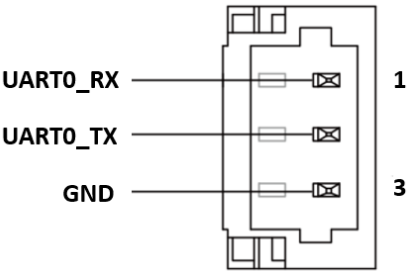

Pin	Signal Description
1	UART0_RX
2	UART0_TX
3	GND

2.4.2 UART Connector (CN3)

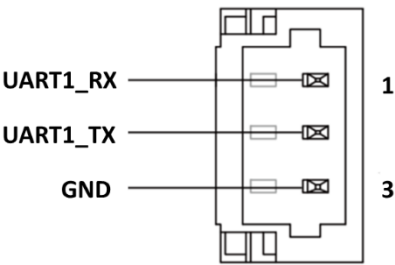

Pin	Signal Description
1	UART1_RX
2	UART1_TX
3	GND

2.4.3 Mini-Card Connector (CN4)

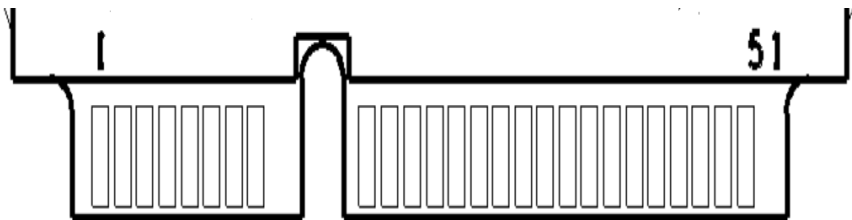

Pin	Signal Description	Pin	Signal Description
1	X_PTN	27	GND
2	3.3V_M2	28	NC
3	NC	29	GND
4	GND	30	NC
5	NC	31	NC

Pin	Signal Description	Pin	Signal Description
6	NC	32	NC
7	NC	33	NC
8	NC	34	GND
9	GND	35	GND
10	NC	36	USB_D-
11	NC	37	GND
12	NC	38	USB_D+
13	NC	39	3.3V_M2
14	NC	40	GND
15	GND	41	3.3V_M2
16	NC	42	NC
17	NC	43	GND
18	GND	44	NC
19	NC	45	NC
20	X_PTN	46	NC
21	GND	47	NC
22	NC	48	NC
23	NC	49	NC
24	3.3V_M2	50	GND
25	NC	51	NC
26	GND	52	3.3V_M2

# Appendix A

---

Toolchain User Manual

## A.1 Toolchain User Manual

---

The following attachment, Toolchain User Manual, is supplied with this document and is meant for use with AAEON products featuring the Kneron KL520 NPU Module. If you have any questions regarding this document or your AAEON product, please contact your sales representative for assistance.