

BOXER-6839

Supplier: POKI / Carton size: 412(L)*306(W)*285(H) mm

Package Drop Test Report

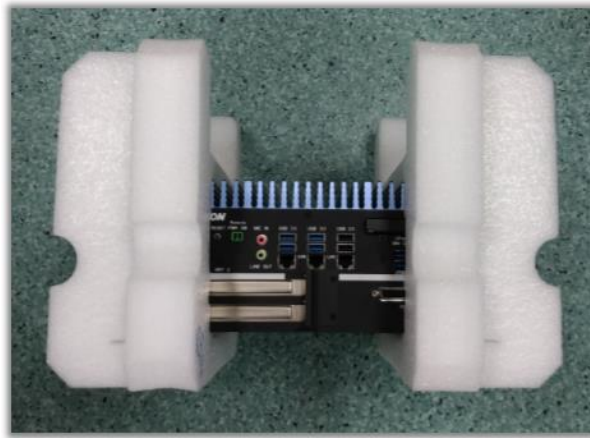

Summary	<p><input checked="" type="checkbox"/> PASS</p> <p><input type="checkbox"/> Fail Note : There is/are ___ defect(s) not list in the report, please check it in the DTS Website.</p> <p><input type="checkbox"/> Pass with Deviation</p>
---------	---

Issue date

2017-05-15

Approval

Tony Liang

Test Engineer

ET Chen

Test item list

1. *Test item list* ----- 2
2. *Configuration of EUT* ----- 3
3. *Package drop test* ----- 5

Testing Result

Num	Test item list	Result	Remark
1	Package drop test	Pass	

Configuration of EUT

Num	Item	Device Information
1.	Model Name	BOXER-6839
2.	M/B Name	PBA-SKS01
3.	BIOS / Version	B839AM02
4.	CPU	Intel® Core™ i3/i5/i7 Processors
5.	Memory Type	Supports 1866/2133MHz and up to 32GB Support un-buffered and non-ECC type SODIMM
6.	SATA SSD	Transcend SSD370 SATA 6Gb/s
7.	Test Software	Windows 8 / Run PassMark Burn In Test 8.1 Pro
8.	Adapter	Adapter.AC/DC.input AC.90-264.output DC.12V.3.33A.40W.2p phoenix.FSP.FSP040-RHAN2

Photos After Test

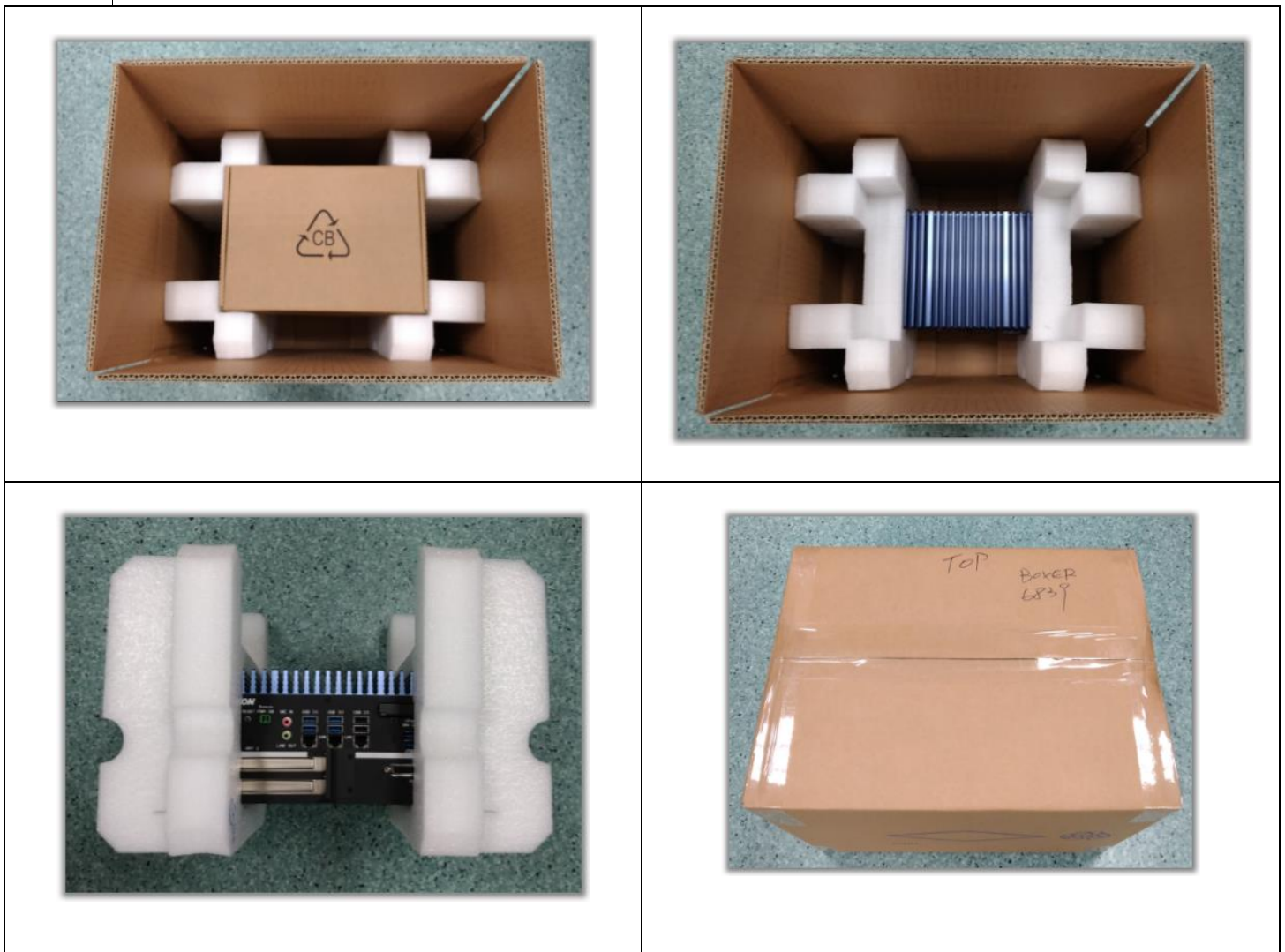

Package Drop Test

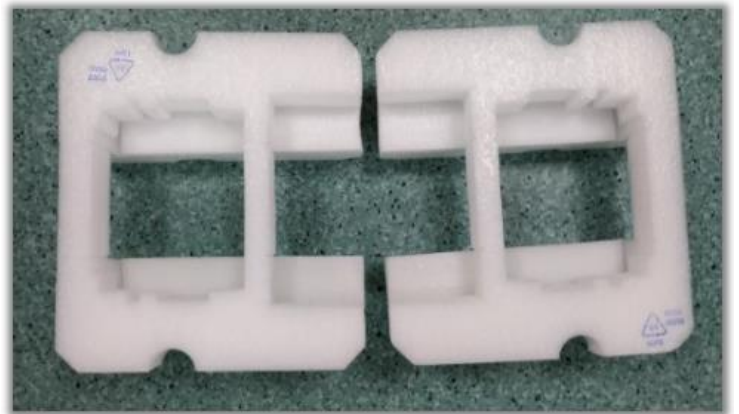
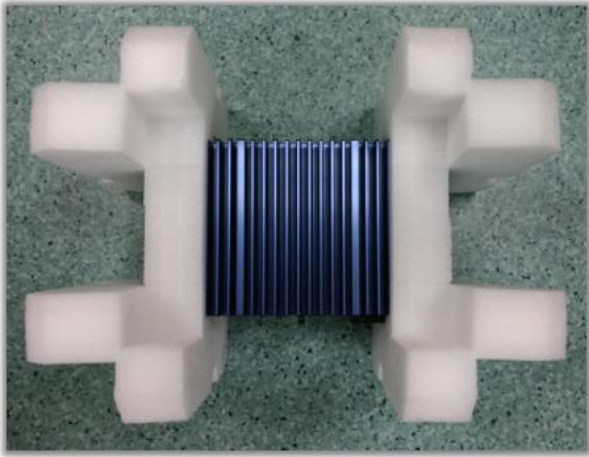

Package Drop Test

Test Date: 05-15-2017

Test Product: BOXER-6839

Test Site: PO KI PAPER CONTAINER. ,LTD

Test Standard:

Reference ISTA PROJECT 1A

Test Equipment:

Drop Tester

KING DESIGN Co. LTD

Model: KD-128A

Serial Number: UU110099185

Test Condition:

1. Test Phase: One corner. Three edges. Six face
2. Test Cycle: 1 Cycle
3. Test Height: 76cm
4. Test Weight:6.0Kg
5. Sample Package: 1unit in single-package.
6. Test Drawing:

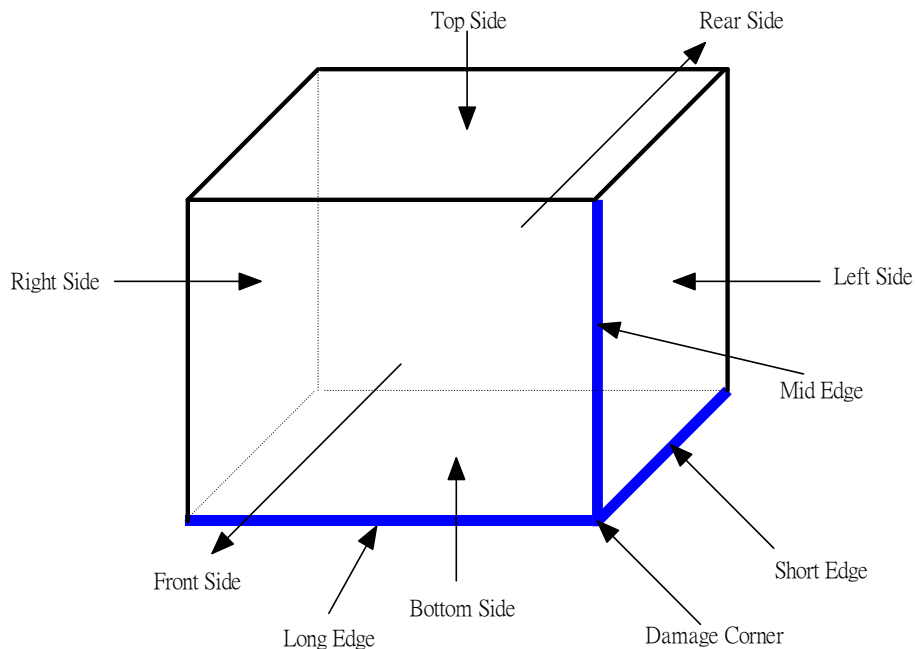

Test Result:

The EPE structure is OK, System no structure deformation and function was working normally after drop test.