

Notice

This guide is designed for experienced users to setup the system in the shortest time.

Safety Precautions

Warning!



Always completely disconnect the power cord from your board whenever you are working on it. Do not make connections while the power is on, because a sudden rush of power can damage sensitive electronic components.

Caution!



Always ground yourself to remove any static charge before touching the board. Modern electronic devices are very sensitive to static electric charges. Use a grounding wrist strap at all times. Place all electronic components on a static-dissipative surface or in a static-shielded bag when they are not in the chassis



Product Warranty

First of all, thank you for purchasing PER-1603 PCI RS-232 Isolation Card. This Quick Installation Guide will help you on the process of the installation. Please read it thoroughly before you start to install it. You may visit AAEON website for the latest version of the instruction. Please refer to [Http://www.aaeon.com](http://www.aaeon.com)

All products in AAEON are designed as the strictest specifications to ensure that the products will own the reliable performance in the typical industrial environments. Whether your purchase from AAEON is made to the purpose of the laboratory or the factory facility, you can be assured that every purchase in AAEON will provide the reliability and stability of operation.

Technical Support

For the most frequently asked questions, you can easily find solutions in your product documentation. The guide is detailedly specified and please refer to it first. We strongly suggest you to read it before asking for a customer service over the phone. If you still cannot find the answer, please give a call to your dealer. All dealers of AAEON are well-trained and ready to provide you as many supports as we can. Based on the customer service we've encountered until now, most of problems are minor and able to be easily solved over the phone. We are always pleased to give advice regarding any installation and operation for AAEON products.

Ordering Information

- **TF-PER-1603-A10**

2-port Isolated RS-232 PCI Communication Card

Packing List

- 1 TF-PER-1603-A10
- 1 Quick Installation Guide
- 1 Utility CD

Content

Product Warranty.....	2
Ordering Information.....	3
Packing List	3
Features.....	5
Specification.....	5
Mechanical Drawing	6
Card Installation.....	7

Features

- Isolation protection for RS-232
- PCI Specification 2.1/2.2 compliant
- I/O address automatically assigned by PCI plug-and play
- Windows XP Support

Specification

- | | |
|-------------------------|---|
| • Form Factor | PCI Communication card
(123mm x 92 mm) |
| • Controller | Oxford 16PCI952 |
| • Speed | RS-232: 50~203.4k |
| • Function | 2 Isolated RS-232 |
| • Power Requirement | +5V only |
| • Operating Temperature | 32 °F~149 °F (0°C~65°C) |

Mechanical Drawing

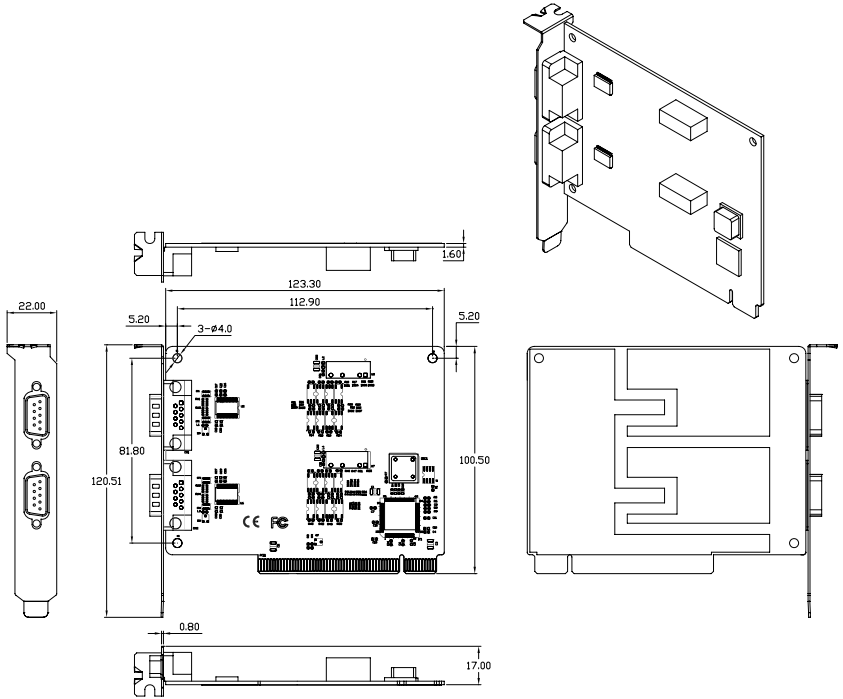

Card Installation

Note:

We strongly recommend you to install the software driver before you install the hardware into your system. It will guarantee a smooth and trouble-free installation process.

Turn off your PC's power supply before you install or remove the PCI communication card and its cables. Static electricity may easily damage computer equipment. Ground yourself by touching the chassis of the computer (metal) before you touch any boards.

Step 1- Install the ***UART_Driver_v6.5.1.5*** driver

Step 2- Turn off the computer and all peripheral devices (such as printers and monitors)

Step 3- Disconnect the power cord and any other cables from the back of the computer

Step 4- Remove the cover of PC

Step 5- Install and plug the PCI communication card on your PCI BUS.

Step 6- Close the cover of PC

Step 7- Connect the cables you removed in step 3

Step 8- Turn on the computer

Step 9- The driver of PCI Communication card will be installed automatically

Step 10- Test your COM port and verify if COM port could work normally

Below Table for China RoHS Requirements

产品中有毒有害物质或元素名称及含量

AAEON Main Board/ Daughter Board/ Backplane

部件名称	有毒有害物质或元素					
	铅 (Pb)	汞 (Hg)	镉 (Cd)	六价铬 (Cr(VI))	多溴联苯 (PBB)	多溴二苯醚 (PBDE)
印刷电路板 及其电子组件	×	○	○	○	○	○
外部信号 连接器及线材	×	○	○	○	○	○
<p>O: 表示该有毒有害物质在该部件所有均质材料中的含量均在 SJ/T 11363-2006 标准规定的限量要求以下。</p> <p>X: 表示该有毒有害物质至少在该部件的某一均质材料中的含量超出 SJ/T 11363-2006 标准规定的限量要求。</p> <p>备注：此产品所标示之环保使用期限，系指在一般正常使用状况下。</p>						