

FOR RoHS

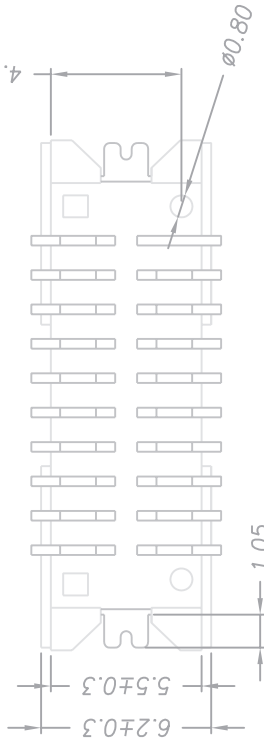
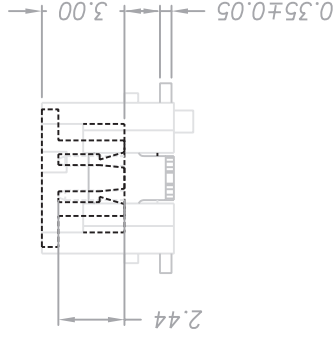
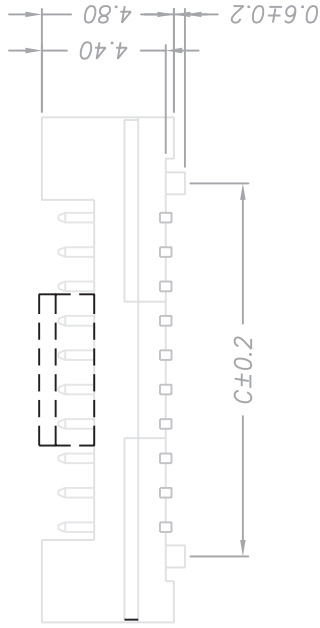
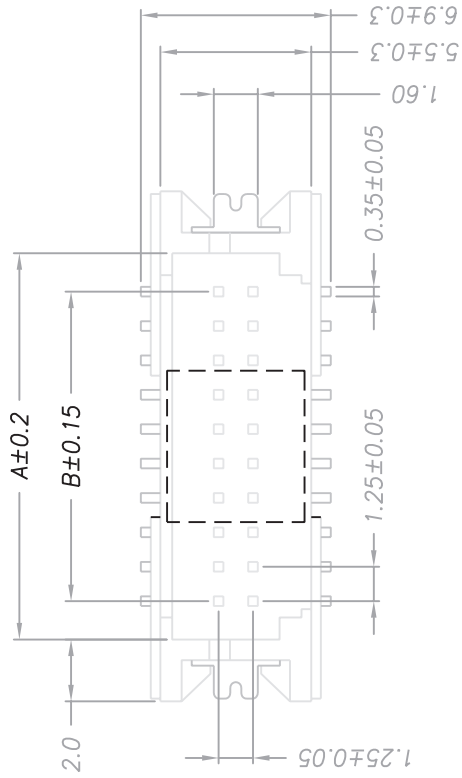

MATERIAL: PHOSPHOR BRONZE, TIN PLATED or GOLD FLASH
 CONTACT: NYLON 9T UL 94V-0

SPECIFICATION

CURRENT RATING: 1A AC/DC
 VOLTAGE RATING: 150V AC/DC
 CONTACT RESISTANCE: 30mΩ MAX.
 INSULATION RESISTANCE: 500MΩ MIN.
 WITHSTANDING VOLTAGE: 500V AC/MINUTE
 TEMPERATURE RANGE: -25°C TO +85°C

PART NO.	Dimensions		
	A	B	C
10PIN	8.09	5.00	7.50
20PIN	14.34	11.25	13.75
30PIN	20.59	17.50	20.00
40PIN	26.84	23.75	26.25



E.I.C.E.-CALL ENTERPRISE CO.,LTD.

TITLE: Crimp Style Conn. Wafer
 1.25mm SMT

PART NO: 0110-01-553-XX0	UNITS: mm	SCALE: 1:1
DWG NO: 95082100-0554	SHEET	

APPD: 陳德勝	MAT'L:
CHKD: Chun.Ter.Chiu	BODY:
DRWN: Wen.Kai	CLIENT: 09-70
DATE	DESCRIPTION

REV. A	NEW RELEASE
--------	-------------