

ARC-625M

2U 3-Slot Rackmount Chassis, Main Board Support

Front View

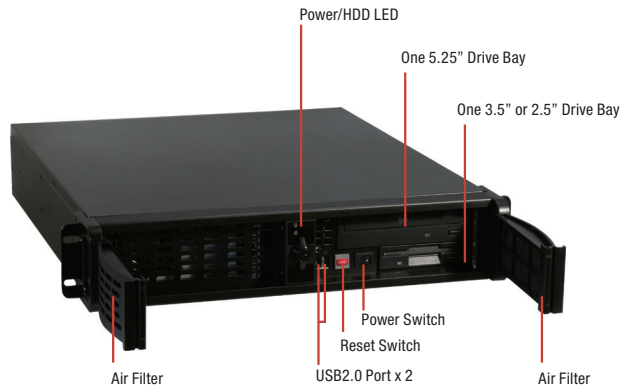

Front View



Top View

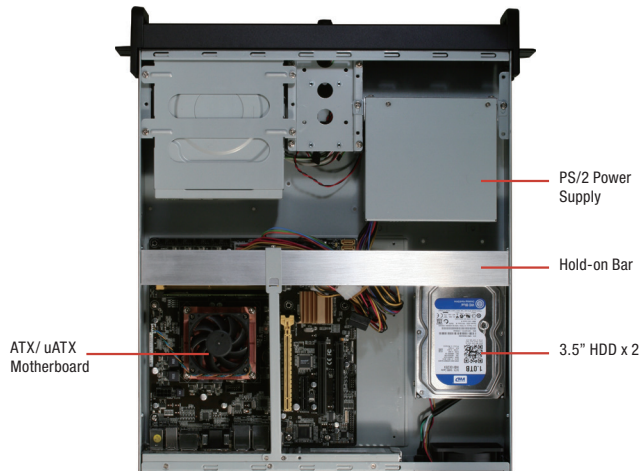

Rear View

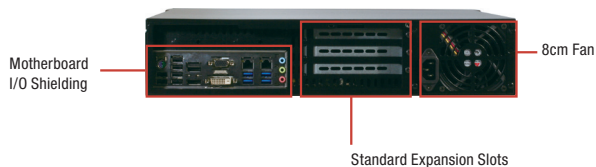

Features

- 2U Height 19" Rackmount Chassis
- Industrial ATX/uATX/Mini-ITX Motherboard
- Standard PS2 AT/ATX Power
- 5.25" x 1 and 3.5" x 1 Front Access Drive Bays
- 3.5" x 2 Internal Drive Bays
- Dual Lockable Front Doors Added Protection
- USB2.0 x 2 On Front Panel



Specifications

System	
Construction	1.2mm SECC Zinc-Coated Steel
Storage	External: 3.5" Disk Drive x 1 5.25" CD-ROM or Removable Hard Disk Drive x 1 Internal: 3.5" Hard Disk Drive Bay x 2
System Fan	8cm Ball Bearing Fan with Removable Filter x 1
Front Panel	Power ON/OFF Switch x 1 Reset Button x 1 Power ON LED x 1 Hard Disk Drive Active LED x 1 USB x 2
Expansion	PCI via riser card x 3, supports max. 167 mm (length) for expansion card
Color	Black
Dimensions	19" (W) x 20.8" (D) x 3.5" (H) (482mm x 528mm x 88.2mm)
Carton Size	21.6" (W) x 27" (D) x 8.8" (H) (548mm x 685mm x 224mm)
Net Weight	22 lb (10 kg)
Gross Weight	26.4 lb (12 kg)
Environmental	
Operating Temperature	32°F ~ 122°F (0°C ~ 50°C)
Storage Temperature	-4°F ~ 176°F (-20°C ~ 80°C)
Storage Humidity	10 ~ 90% @ 40°C, non-condensing
Vibration	0.5 Grms/ 5 ~ 500Hz/ operation (2.5" Hard Disk Drive) 1.5 Grms/ 5 ~ 500Hz/ non operation
Shock	15 G peak acceleration (11 m sec. duration), operation 30 G peak acceleration (11 m sec. duration), non operation
EMC	CE/FCC Class A

Dimension

Unit: mm

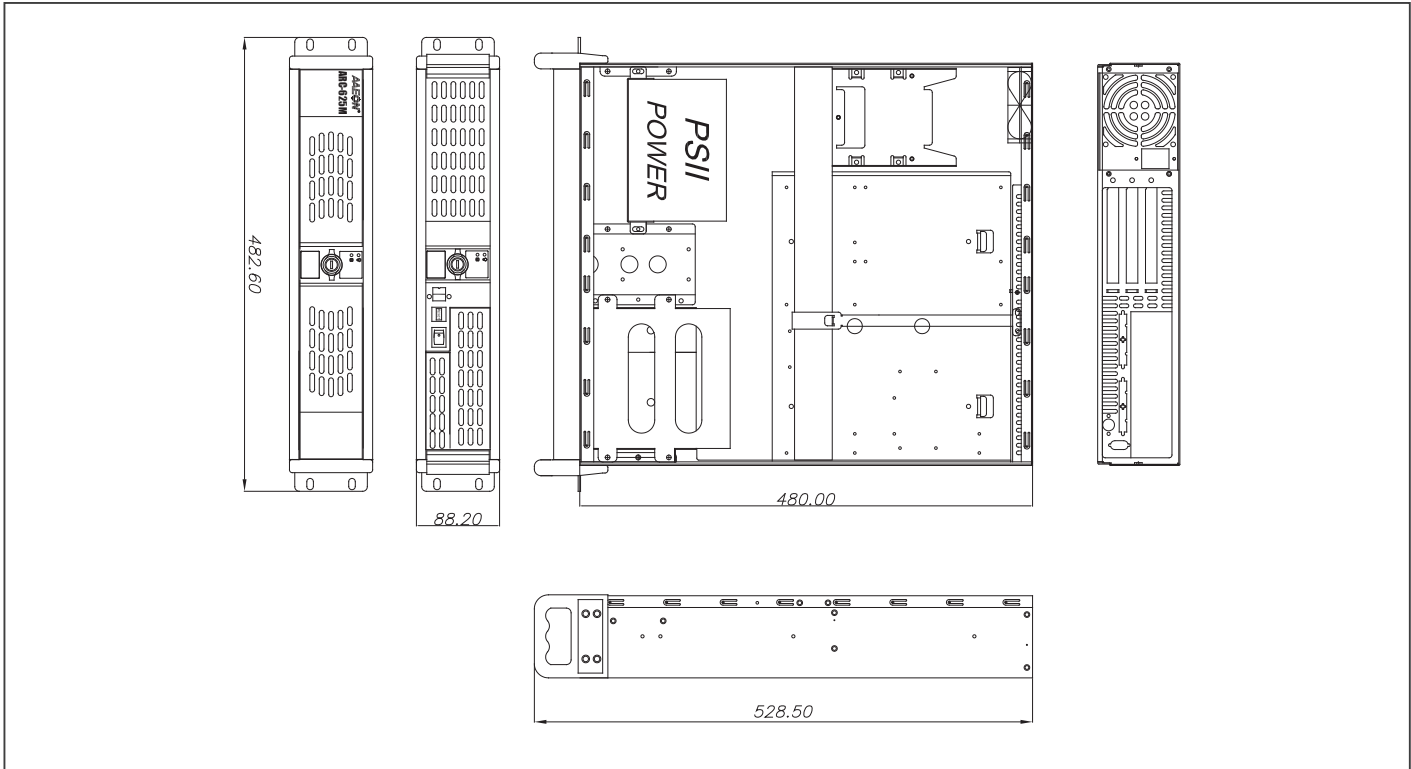

Power Supply Options

P/N	TYPE	PFC Support	Input Voltage	Watt	Size
1255304003	ATX	Active PFC	Auto 90 ~ 264V	400W	PS2

Industrial Motherboard Options

CPU Card	CPU Level	Remark
IMBA-H61A	Socket LGA1155, Intel® 2nd/3rd Generation Core™ i3/i5/i7 CPU, TDP 95W	Recommend with Min. 300W Power supply
IMBA-Q87A	Socket LGA1150, Intel® 4th Generation Core™ i3/i5/i7 CPU, TDP 95W	Recommend with Min. 400W Power supply
IMBM-B75A	Socket LGA1155, Intel® 2nd/3rd Generation Core™ i3/i5/i7 CPU, TDP 95W	Recommend with Min. 400W Power supply
IMBM-H61A	Socket LGA1155, Intel® 2nd/3rd Generation Core™ i3/i5/i7 CPU, TDP 95W	Recommend with Min. 300W Power supply
IMBM-Q87A	Socket LGA1150, Intel® 4th Generation Core™ i3/i5/i7 CPU, TDP 95W	Recommend with Min. 400W Power supply
IMBA-Q77	Socket LGA1155, Intel® 3rd Generation Core™ i3/i5/i7 CPU, TDP95W	Recommend with Min. 400W Power Supply
IMBA-967	Socket LGA1155, Intel® Core™ i3/i5/i7 CPU, TDP 95W	Recommend with Min. 400W Power Supply

Ordering Information

P/N	Description
TF-ARC-625M-B	Rackmount 2U Chassis, Bare for Motherboard & PS2 Power, PS_SW (ATX), Black

CPU Cooler Options

Model/Name	Description
175920000D	LGA1155/1150 CPU Cooler (2U)
1759218000	LGA1155/1150 CPU Cooler (1.5U)
175920000G	LGA775 CPU Cooler (1U)
1759200335	LGA775 CPU Cooler (1U)

Riser Card Options

Model/Name	Description
96866660W	PCIe[x4] to PCIe[x4] x 1 Riser Card, 10 cm