

ARC-645-S

4U 10-slot Rackmount Chassis

Half-size Cards Support

04

Industrial Chassis - Rackmount

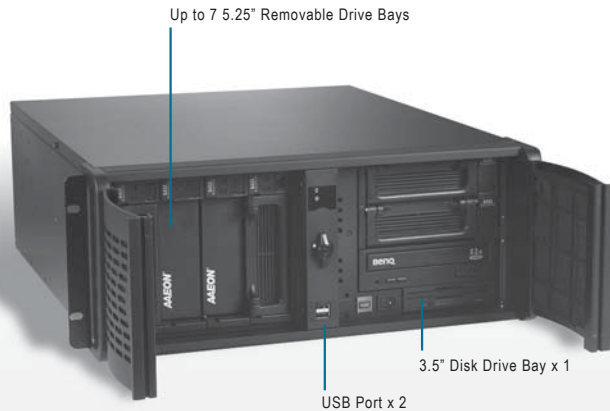

Features

- 4U Height 19" Rackmount Chassis
- 10-slot PICMG PCI Bus Passive Backplanes
- Standard PS/2 ATX and Mini-redundant Power Supplies
- 5.25" x 7 and 3.5" x 1 Disk Drive Bay for Front-accessible Disk Drives
- Internal 3.5" x 1 Disk Drive Bay For Hard Disks
- Lockable Front Doors for Protecting The Running System
- USB x 2 and Keyboard Connector x 1 On Front Panel



CE FC



Specifications

System	
Construction	1.2mm SECC Zinc-Coated Steel (Japanese Manufactured)
Storage	External: 3.5" Floppy disk drive x 1 5.25" CD-ROMs or Removable Hard Disk Drive x 7 Internal: 3.5" Hard Disks Drive Bay x 1
System Fan	8cm Ball Bearing Fans with Removable Filter x 2
Front Panel	Power ON/OFF Switch x 1 Reset Button x 1 Power ON LED x 1 HDD Active LED x 1 LAN LED x 1 USB Port x 2 PS2 Keyboard x 1
Rear Panel	Reserved cutout for DB-9 connector x 2 Reserved cutout for DB-25 connector x 1 PS2 keyboard x 1
Color	Black
Dimensions	19"(W) x 20.8"(D) x 7"(H) (482mm x 528mm x 177mm)
Carton Size	21.6"(W) x 27"(D) x 12.4"(H) (548mm x 685mm x 315mm)
Net Weight	26.4 lb (12 kg)
Gross Weight	30.8 lb (14 kg)
Environmental	
Operating Temperature	32°F ~ 122°F (0°C ~ 50°C)
Storage Temperature	-4°F ~ 176°F (-20°C ~ 80°C)
Operating Humidity	10 ~ 90%
Storage Humidity	10 ~ 90% @ 40°C, non-condensing
Vibration (HDD rack excluded)	0.5G / 5 ~ 500Hz / operation (2.5" Hard Disk Drive) 1.5G / 5 ~ 500Hz / no operation
Shock (HDD rack excluded)	15G peak acceleration (11 m sec. duration), operation 30G peak acceleration (11 m sec. duration), non operation
EMC	CE/FCC Class A

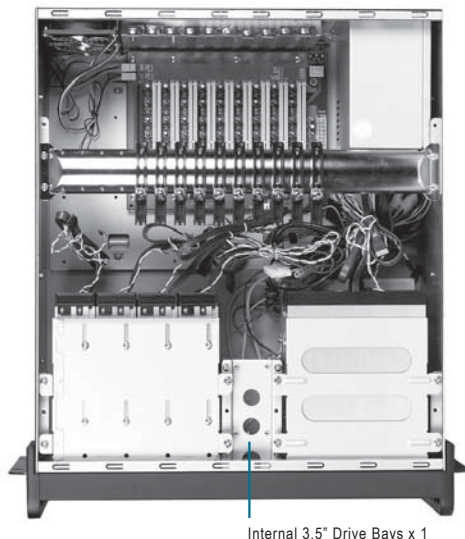

Dimension Unit: mm

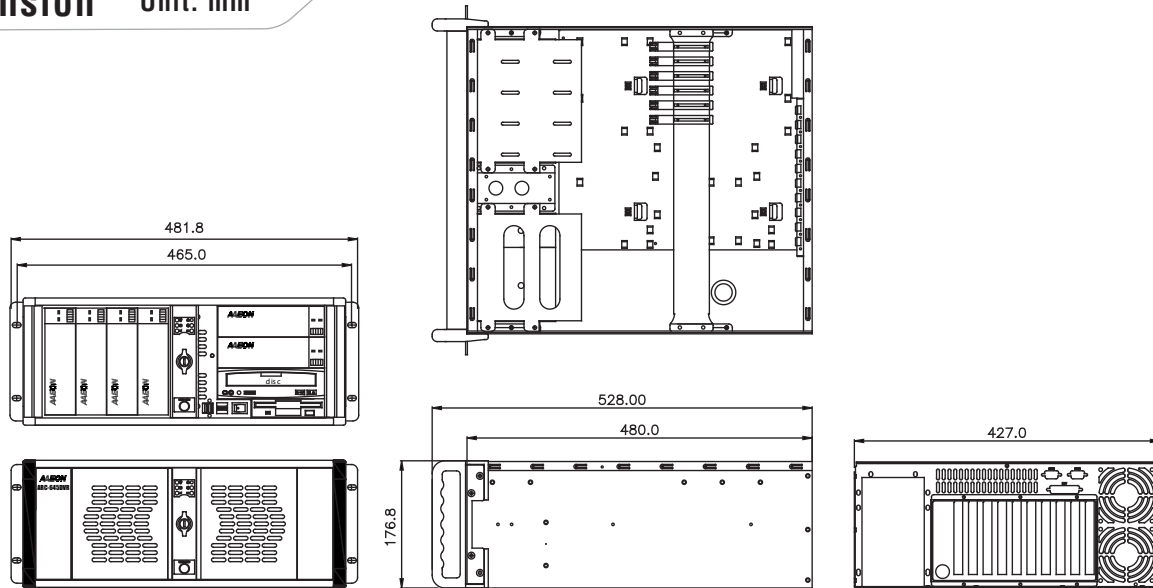

Power Supply Options

P/N	TYPE	PFC Support	Input Voltage	Watt	Size
TF-PW-S300-S-01	ATX	Passive PFC	Switch 115/230V	300W	PS2
TF-PW-Z350-A-01	ATX	Active PFC	Auto 115-230V	350W	PS2
TF-PW-Z350-A-00	ATX	Active PFC	Auto 115-230V	350W	PS2
TF-PW-Z400-A-01	ATX	Active PFC	Auto 100-240V	400W	PS2
TF-PW-R460-A-00	ATX	Active PFC	Auto 100-240V	460W Redundant	PS2

Backplane Options

P/N	Description	Master Interface	Slots	Power Connector, ATX Extend Function
TF-BP-210SP-P9-A10	Rackmount, PCI, 10-slot Backplane, 9 PCI, Single segment	PCI	9/ 1 (PCI/ PICMG_PCI)	ATX, 3-pin ATX extend

CPU Card Options

Model/Name	Description	Master Interface
TF-HSB-835P	Socket 478 P4/ Celeron® up to 3.2GHz (400/533/800)	PCI
TF-HSB-811P	On board Celeron® M (600MHz)/ Socket 479 P-M(1.2GHz)/ Celeron® M (900 MHz)	PCI

Ordering Information

P/N	Description	Remark
TF-ARC-645-S-B	4U Industrial Bare Chassis, for 10-slot Backplane & PS2 Power, PS_SW (ATX), Color: Black	