

ARC-636M

3U 7-slot Rackmount Chassis, Industrial Main Board Support

04

Industrial Chassis - Rackmount

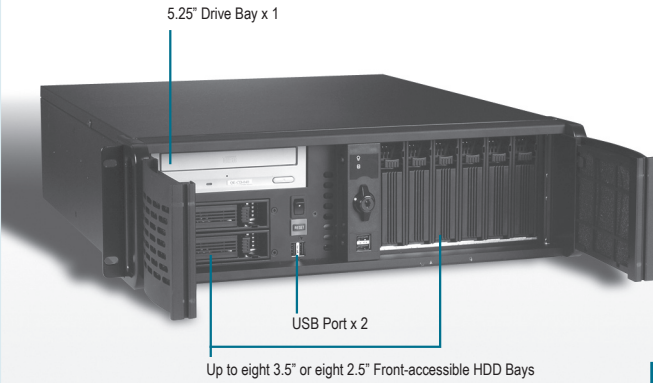

5.25" Drive Bay x 1

USB Port x 2

Up to eight 3.5" or eight 2.5" Front-accessible HDD Bays



Features

- 3U Height 19" Rackmount Chassis
- System Fan x 2 Support Cool Down CPU & Key Components Temperature
- Standard Motherboard ATX, Micro ATX Form Factor
- 3U ATX Power
- 5.25" x 1 and 3.5" x 8 Front-accessible Hard Disk Drive Bays
- Lockable Front Doors For Protecting The Running System
- USB Port x 2 On Front Panel



Specifications

System	
Construction	1.2mm SECC Zinc-Coated Steel (Japan Manufactured)
Storage	External: 5.25" CD-ROM Drive x 1 3.5" Removable Hard Disk Drive Bay x 8
System Fan	6cm Ball Bearing Fan On Rear Side x 2
Front Panel	Power ON/OFF Switch x 1 Reset Button x 1 Power ON LED x 1 HDD Active LED x 1 USB Port x 4
Rear Panel	Standard ATX platform I/O Bracket
Color	Black
Dimensions	19"(W) x 18.9"(D) x 5.2"(H) (482mm x 480mm x 132mm)
Carton Size	21.3"(W) x 26"(D) x 9.3"(H) (541mm x 660mm x 236mm)
Net Weight	22 lb (10 kg)
Gross Weight	26.4 lb (12 kg)
Environmental	
Operating Temperature	32°F ~ 122°F (0°C ~ 50°C)
Storage Temperature	-4°F ~ 176°F (-20°C ~ 80°C)
Operating Humidity	10 ~ 90%
Storage Humidity	10 ~ 90% @ 40°C, non-condensing
Vibration (HDD excluded)	0.5G / 5 ~ 500Hz / operation (2.5" Hard Disk Drive) 1.5G / 5 ~ 500Hz / non operation
Shock (HDD excluded)	10G peak acceleration (11 m sec. duration), operation 20G peak acceleration (11 m sec. duration), non operation
EMC	CE/FCC Class A



6cm Fan x 2

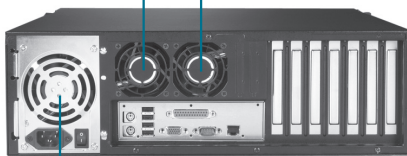

3U ATX Power



ARC-636M

Dimension Unit: mm

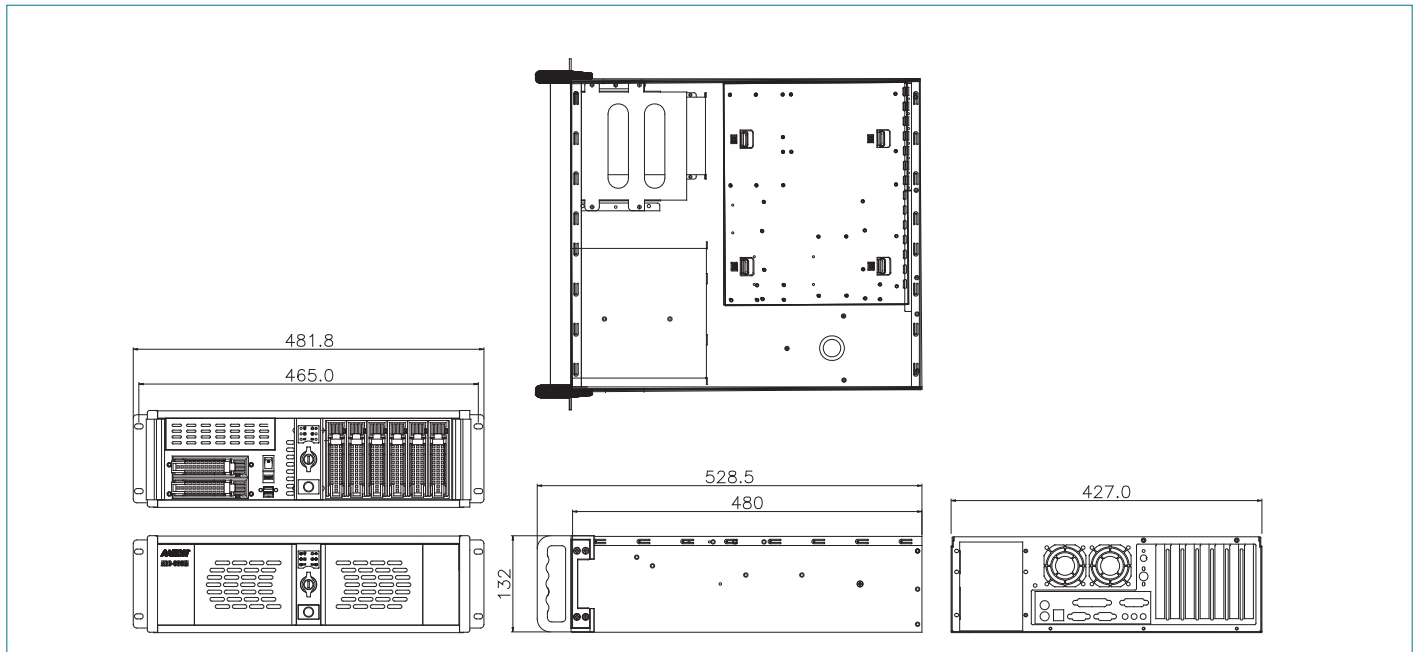

Power Supply Options

P/N	TYPE	PFC Support	Input Voltage	Watt	Size
TF-PW-L460-A-00	ATX	Active PFC	Auto 115-230V	460W	3U (18 cm)

Industrial Motherboard Options

CPU Card	CPU Level	Remark
TF-IMBA-910	Socket LGA775, Pentium® D/ Core™ 2 Duo CPU up to 2.66GHz (533/800/1066 MHz)	Recommend with Min 300W Power Supply
TF-IMBA-880	Socket LGA775, Pentium® 4/ Celeron® D CPU up to 3.8GHz (533/800/1066 MHz)	Recommend with Min 300W Power Supply
TF-IMBM-935	Socket LGA775, Core™ 2 Duo/ Core™ 2 Quad CPU up to 2.66GHz (800/1066 MHz)	Recommend with Min 300W Power Supply
TF-IMBM-700	VIA C7 1.0GHz onboard (FSB 400MHz)	

Ordering Information

P/N	Description	Remark
TF-ARC-636M-B	3U Industrial Chassis Bare for Motherboard & 3U Power, PS_SW (ATX), Color: Black	