

# ARC-615H

## 1U 4-slot Rackmount Chassis, Half-size CPU Cards Support

04

Industrial Chassis - Rackmount

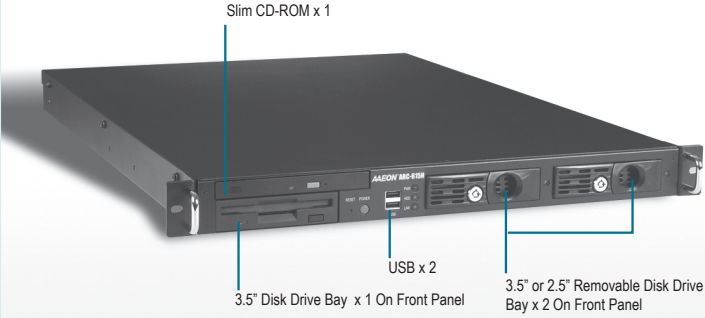

### Features

- 1U Rackmount Chassis
- 4-slot PICMG PCI Bus Passive Backplanes
- Standard 1U Power Supply Up to 300W
- Front Panel 3.5" or 2.5" Disk Drive Bay x 2 For Removable Hard Disk Drive
- Front Panel 5.25" Disk Drive Bay For Slim CD-ROM x 1
- Front Panel 3.5" Disk Drive Bay For Floppy Disk Drive x 1
- USB Port x 2 On Front Panel



### Specifications

System	
Construction	Heavy-duty Steel
Storage	External: 3.5" Floppy Disk Drive x 1 5.25" Slim CD-ROM Drive x 1 3.5" Removable Hard Disk Drive x 2
	Internal: 3.5" Hard Disk Drive Bay x 1
System Fan	4cm Ball Bearing Fan on Right Side x 2 4cm Ball Bearing Fan for CPU Card x 2
Front Panel	Power ON/OFF Switch x 1 Reset Button x 1 Power LED x 1 Hard Disk Drive Active LED x 1 LAN LED x 1 USB Connector x 2
Rear Panel	Reserved cut-out for DB-25 connector x 1 Reserved cut-out for DB-9 connector x 1
Color	Black
Dimensions	18.8"(W) x 23.6"(D) x 1.7"(H) (478mm x 600mm x 44mm)
Carton Size	20.5"(W) x 27.2"(D) x 5.9"(H) (520mm x 690mm x 150mm)
Net Weight	26.4 lb (12 kg)
Gross Weight	33 lb (15 kg)
Environmental	
Operating Temperature	32°F ~ 104°F (0°C ~ 40°C)
Storage Temperature	-4°F ~ 176°F (-20°C ~ 80°C)
Operating Humidity	10 ~ 90%
Storage Humidity	10 ~ 90% @ 40°C, non-condensing
Vibration	0.5G / 5 ~ 500Hz / operation (2.5" Hard Disk Drive) 1.5G / 5 ~ 500Hz / non operation
Shock	10G peak acceleration (11 m sec. duration), operation 20G peak acceleration (11 m sec. duration), non operation
EMC	CE/FCC Class A

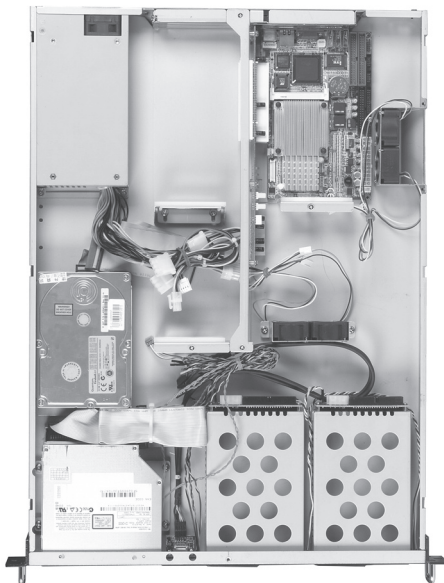

# ARC-615H

Dimension Unit: mm

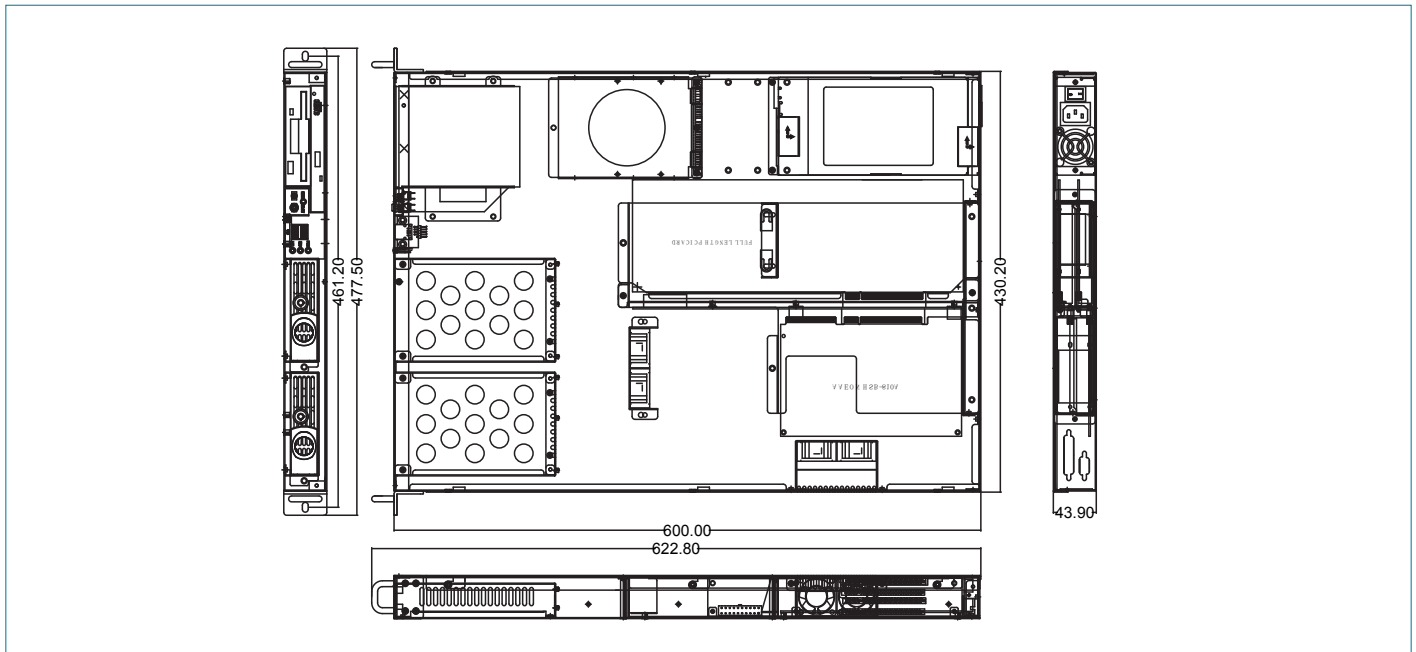

## Power Supply Options

P/N	TYPE	PFC Support	Input Voltage	Watt	Size
TF-PW-H150-A-00	ATX	Active PFC	Auto 115-230V	150W	1U (18.5cm)
TF-PW-H200-A-00	ATX	Active PFC	Auto 115-230V	200W	1U (20.5cm)
TF-PW-H250-A-01	ATX	Active PFC	Auto 100-240V	250W	1U (20.5cm)
TF-PW-H300-A-00	ATX	Active PFC	Auto 100-240V	300W	1U (20.5cm)

## Passive Backplane Options

P/N	Description	Master Interface	Slots	Power Connector, ATX Extend Function
TF-BP-204VP-P3-A10	Rackmount, PCI, 4-slot Backplane, 3 PCI, Single Segment	PCI	3/ 1 (PCI/ PICMG_PCI)	ATX, 3-pin ATX extend

## CPU Card Options

Model/Name	Description	Master Interface
TF-HSB-965P	Socket 478 Core™ 2 Duo (533/667/800) w/o CompactFlash™,	PCI
TF-HSB-811P	Onboard Celeron® M (600MHz); Socket 479 Pentium® M (1.2GHz) / Celeron® M (900MHz) w/o CompactFlash™,	PCI

## Ordering Information

Model/Name	Description	Remark
TF-ARC-615H-B	Rackmount 1U Chassis Bare, For IDE HDD use only, 4-slot backplane, Power 1U, PS_SW (ATX), Black	
TF-ARC-615H-B-01	Rackmount 1U Chassis Bare, For SATA HDD use only, 4-slot backplane, Power 1U, PS_SW (ATX), Black	
TF-ARC-615H-B-02	Rackmount 1U Chassis Bare, For SCSI HDD use only, 4-slot backplane, Power 1U, PS_SW (ATX), Black	
TF-ARC-615H-B-03	Rackmount 1U Chassis Bare with Silders, For SCSI HDD use only, 4-slot backplane, Power 1U, PS_SW (ATX), Black	